



CONTRAX

CONTRAX EQUIPMENT INC.
5195 MAINGATE DR.
MISSISSAUGA (ONTARIO) L4W 1G4
CONTRAXEQUIPMENT.COM



**QUALITY
CONSTRUCTION
EQUIPMENT
WEAR PARTS**



CONTRAX

TABLE OF CONTENTS

FOUR REASONS WHY OUR TRACKS SHOULD BE YOUR TRACKS.....	2
TUFFBILT HD STYLE GUIDE	2
OUR TIMELINE	3
CONTRAX ANSWERS	4
TESTIMONIALS	5
SHIPPING TIME	6
TRACK LOADER RUBBER TRACKS	7
TUFFBILT+ RUBBER TRACKS	8
EXCAVATOR TRACKS	9
CRAWLER CARRIER & DUMPER TRACKS	11
NON-MARKING TRACKS	12
SPECIALTY TRACKS	13
NON-METAL CORE	13
DRILL RIG	14
PAVER	14
OTHERS	14
RUBBER PADS	15
SPECIALTY RUBBER PADS	16
FLATPROOF TIRES.....	17
UNDER-CARRIAGE WEAR PARTS	19
IDLER STYLES	20
BOTTOM ROLLER STYLES	21
TOP ROLLER STYLES	21
SPROCKET STYLES	22
HOW TO MEASURE YOUR EQUIPMENT	23 - 26

WELCOME TO THE WORLD OF TUFFBILT

For over a decade, TuffBilt rubber tracks, tires, and parts have been proving their superior quality and value in demanding conditions on construction equipment throughout the world.

Utilizing cutting edge technology, advanced compounds, and superior components, these top quality products meet and exceed all OEM specifications, and deliver the high performance that TuffBilt customers have come to expect.

TuffBilt products are designed and engineered to uncompromising standards to deliver superior durability in extreme conditions, and lower your overall operating costs.

TuffBilt—Setting the standard for performance, quality and value. We move the earth!

TUFFBILT—ENGINEERED TO OUTPERFORM

FOUR REASONS WHY OUR TRACKS SHOULD BE YOUR TRACKS

- 1 OUR ADVANCED RUBBER COMPOUND**
- Precision-manufactured from a combination of high-quality synthetic and virgin natural rubber
 - Superior flexibility
 - Resistance to abrasion and tears

- 2 OUR EXTENSIVE SELECTION OF TREAD PATTERNS**
- Improved traction
 - Enhanced surface protection
 - Available in non-marking compound

- 3 OUR HARDENED, FORGED STEEL DRIVE LINKS**
- Tempered for unmatched strength and durability
 - Helps ensure correct fitment, reliability, and longevity
 - Reduces vibration in virtually any operating condition

- 4 OUR CONTINUOUS STEEL CABLE (CSC) TECHNOLOGY**
- Helically wound to guarantee even strength and weight distribution
 - As an estimated 80% of track failures occur where multiple cords are bonded together, we eliminate those seams to ensure the entire track circumference maintains its integrity for life.



TUFFBILT HD STYLE GUIDE

- **20% More Mass Overall**
Maximizes durability & longevity
- **Thicker Steel Cording**
Superior strength & rigidity
- **Thicker Profile & Extra Steel Cabling** Meets or exceeds OEM Specifications
- **Built-Up Rail**
Virtually eliminates downtime due to derailing

⚠
MANY PRODUCTS TYPICALLY LABELED AS "STANDARD" OR EVEN "PREMIUM" BY OTHER SUPPLIERS OFTEN FEATURE A THINNER, WEAKER CARCASS AND LESS INTERNAL CABLING. **ALWAYS CONFIRM MEASUREMENTS BEFORE YOU BUY!**

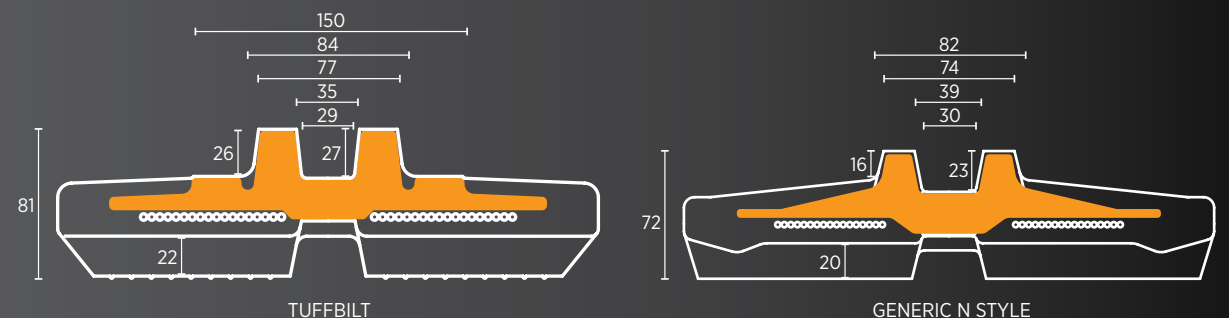

OUR TIMELINE

THE EVOLUTION OF CONTRAX

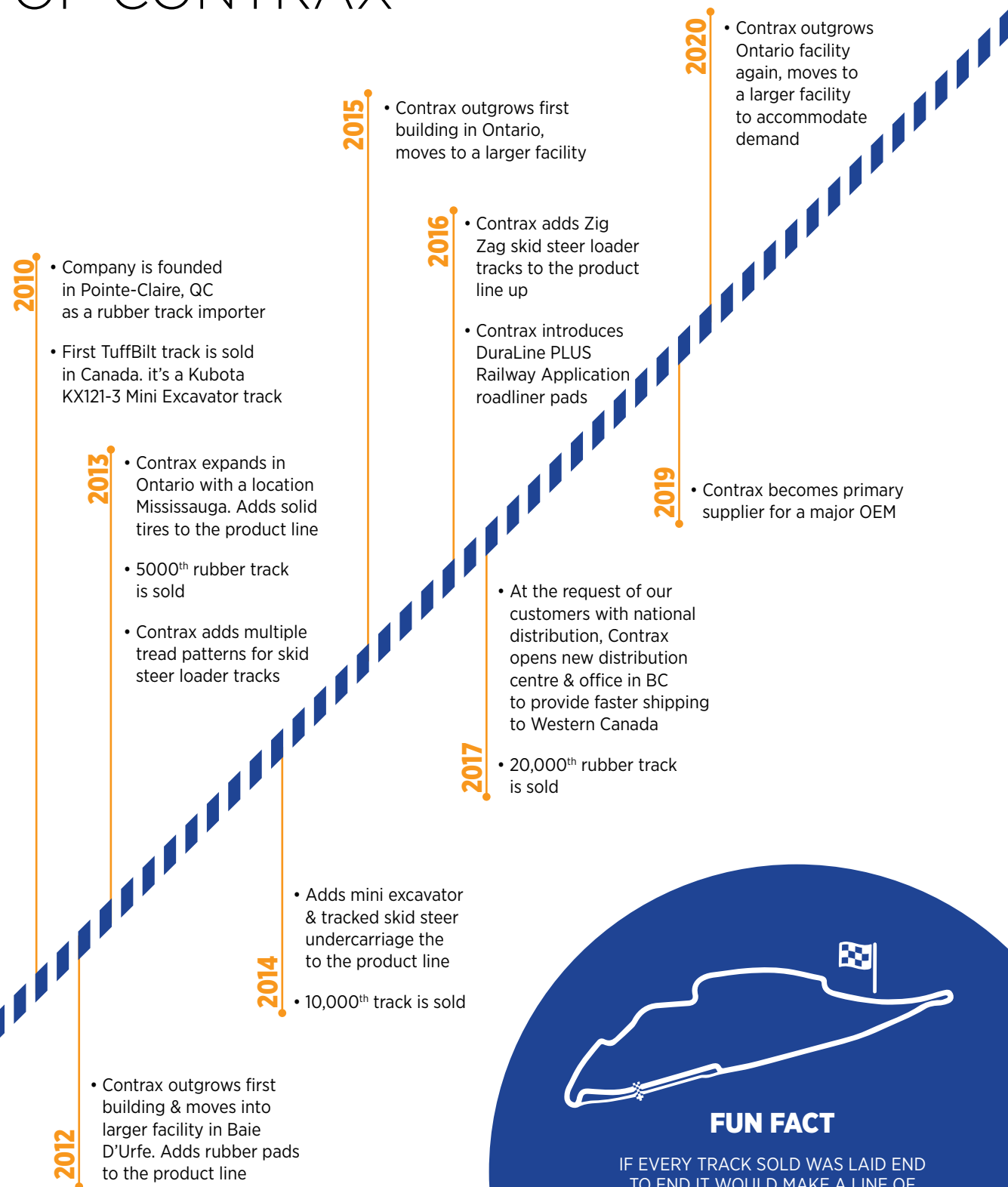

FUN FACT

IF EVERY TRACK SOLD WAS LAID END TO END IT WOULD MAKE A LINE OF RUBBER OVER 220 KM LONG. THAT'S ENOUGH TO GO FROM OTTAWA TO MONTREAL WITH ENOUGH LEFT OVER TO GO AROUND THE CIRCUIT GILLES VILLENEUEVE 6 TIMES.

CONTRAX ANSWERS

YOUR FREQUENTLY ASKED QUESTIONS

IS A HEAVY-DUTY TRACK WORTH THE COST?

Yes. The heavy-duty track has 20-30% more material for 10-20% more in cost. This extra material produces in excess of a 30% increase in product life.

WHICH TREAD PATTERNS FOR MY TRACK LOADER WORK BEST IN SPECIFIC ENVIRONMENTS?

Reference **page 7** for a visual.

HOW DO I KNOW WHICH PART GOES WITH MY MACHINE?

Visit **WWW.CONTRAXEQUIPMENT.COM**, and under the *Rubber Track Selector Tool* search by brand and model, and check to see if the part is listed as fitting. You can also confirm part numbers by calling us at **888 429 4250** and talking with a product specialist. Remember, at Contrax Equipment, parts are **GUARANTEED TO FIT YOUR MACHINE.**

WHAT ARE YOUR RUBBER TRACKS MADE OF?

Our rubber tracks are a blend of natural and synthetic virgin rubber. They're manufactured with continuous steel cording and hardened steel links for durability and longevity. We do not use any recycled rubber.

A AND B TIRES: WHICH SIDE OF THE MACHINE DO THEY GO ON?

It usually doesn't matter which side the A and B tires go on as long as they are on opposite sides!

TO ENSURE SAME DAY SHIPPING, ORDERS SHOULD BE PLACED BY WHAT TIME?

Place your order by 3pm for same day shipping.

HOW DO I MAKE A CLAIM ON A WARRANTY?

Take a minimum of three pictures: the serial number, the entire product, and the failure. Email them to **info@contraxequipment.com** and your rep. Include the date the product was purchased, the date it was installed, and any other details you feel are pertinent to your claim.

SHOULD I MOUNT TRACKS IN A CERTAIN DIRECTION?

Most tracks are non-directional. In the event they are not, the side of the track is marked with arrows.



TESTIMONIALS

WHAT CUSTOMERS SAY ABOUT US

We're extremely satisfied with how our TuffBilt tracks are performing! Their pricing, quality and strong support are why our Rental division has chosen TuffBilt tracks for mud, snow and ice applications.



Johnny J.

Contrax is always my company's first choice for tracks and tires, thanks to the incredible customer service. Their response time to emails and phone calls is within minutes!



Mark F.

Dealing with Contrax as a supplier and now as a customer, i couldn't be happier with the service and quality. The team is great to deal with. Very knowledgeable and gets back to you quickly. In two years of dealing these tracks, we have had zero warranty claims. Price vs quality, these are the best tracks in the industry.



Dale C.

Everyone at your end has been helpful and responsive. I hope to use you more in the future as this has been a painless order. Not what I have experience with other vendors of this type of product!



Mike M.

I love working with Contrax. Everyone is friendly and goes out of their way to help, even the warehouse guys. I wish every supplier was like you.



Louis C.

You guys are the best. You always have it in stock and you always know how to find the parts we need. You will always be my first choice!



Steve B.

SHIPPING TIME

FAST DELIVERY TO YOUR REGION

CALL 888 429 4250

FOR ONE OF OUR AGENTS TO ANSWER ALL YOUR CONSTRUCTION WEAR PARTS AND SHIPPING QUESTIONS.

- NEXT DAY
- 2-3 DAYS
- 1-2 DAYS
- 4-7 DAYS

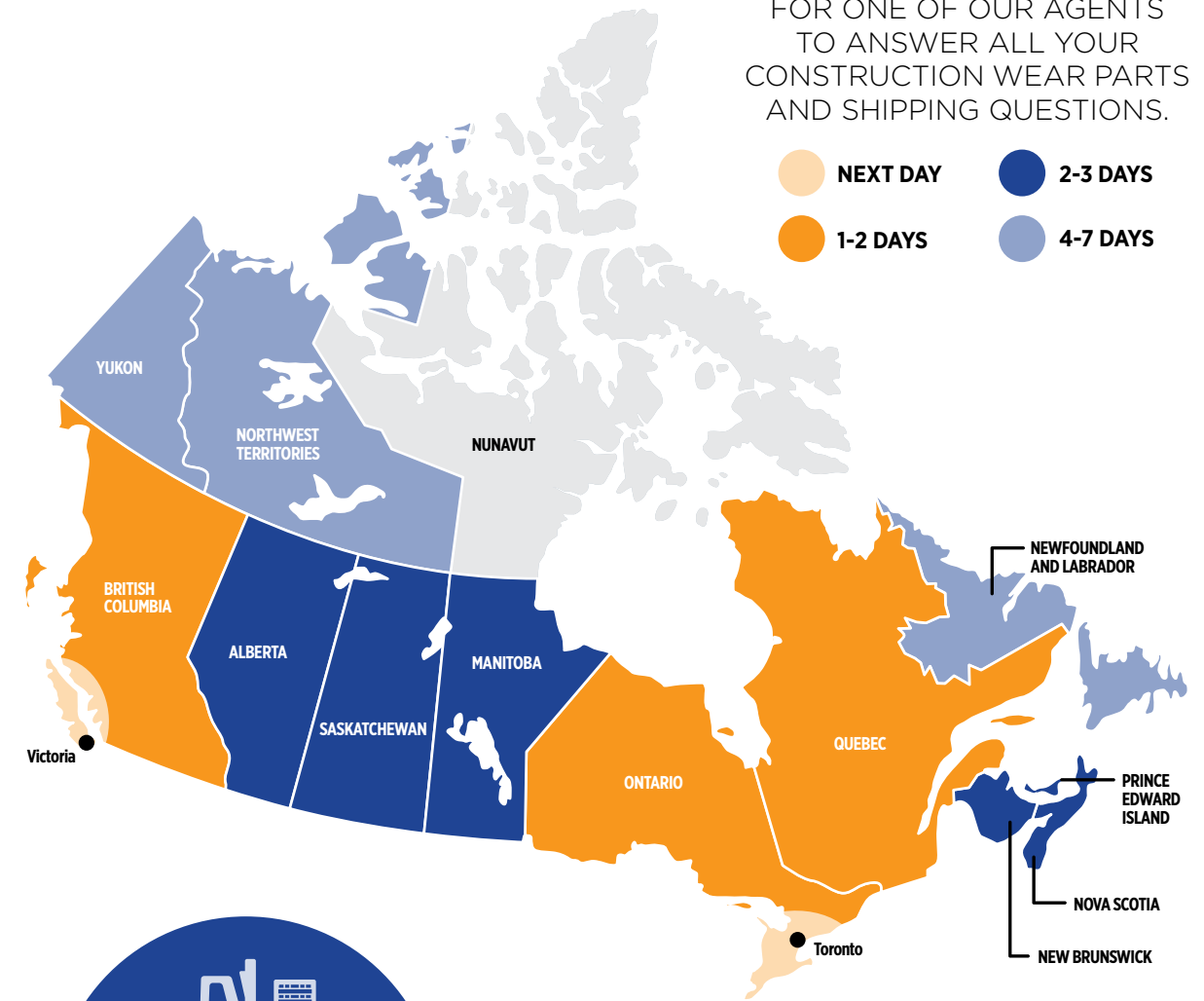

IN STOCK & READY TO SHIP



TRACK LOADER RUBBER TRACKS

OUR TRACK LOADER RUBBER TRACKS ARE GUARANTEED TO FIT YOUR MACHINE!

B-GUIDE STYLE

- Built Up Smooth Rolling Surface for Smooth Ride
- Exact Circumferential Specifications for many CTLs
- Specially Formulated Rubber Compound

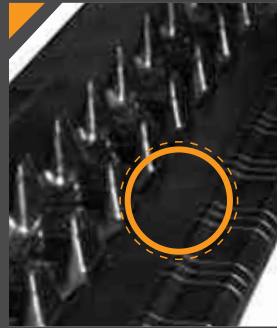

T-GUIDE STYLE

- Raised Blocks for Improved Durability
- Prevents Damage to Rail Surface
- OEM Specifications for Takeuchi®, Gehl®, Mustang® CTL

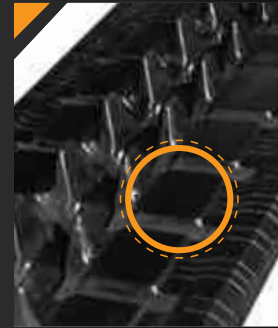

TREAD PATTERN TERRAIN GUIDE

ZIG ZAG



- Dirt
- Mud
- Snow
- Gravel

STAGGERED BLOCK



- Dirt
- Asphalt
- Gravel
- Grass

C-LUG



- Dirt
- Asphalt
- Gravel
- Grass

MULTI BAR



- Dirt
- Snow
- Grass

TUFFBILT+

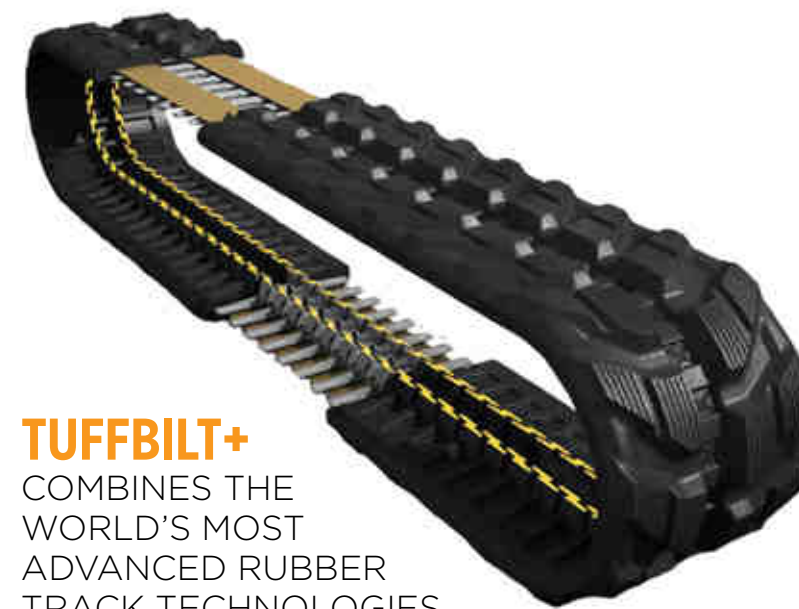

TUFFBILT+
COMBINES THE
WORLD'S MOST
ADVANCED RUBBER
TRACK TECHNOLOGIES

This premium range of innovative rubber track design incorporates several new features making it the new gold standard in the world of rubber tracks.

TuffBilt+ tracks feature toughened steel links linked by continuously wound anti-rust high tensile steel cords encased in an advanced abrasion-resistant rubber carcass which provides increased durability and performance.

The newly developed interlocking steel link configuration is designed to avoid detracking issues even when used on most demanding of terrains. In addition the anti-vibration qualities of the TuffBilt+ design ensures smooth running of track rollers and offers increased operator comfort.



ANTI-VIBRATION

Advanced steel link design ensures smooth running of track rollers and offers increased operator comfort.



ANTI-DETRACKING

Interlocking steel link features prevent detracking issues even when used on demanding terrains.



PREMIUM GRADE
RUBBER



ADVANCED
ENGINEERING



TOUGHENED
STEEL LINKS

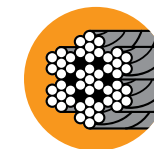

CONTINUOUS
STEEL CORDS



UNIQUE TREAD
DESIGN

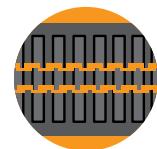

INTERLOCKING
LINK DESIGN



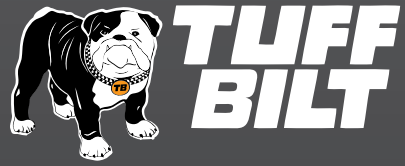

EXCAVATOR TRACKS

TuffBilt Excavator Rubber Tracks are manufactured to exact OEM specifications.

OUR EXCAVATOR TRACKS ARE GUARANTEED TO FIT YOUR MACHINE!

MANY OF OUR TRACKS COME WITH HEAVY DUTY STEEL LINKS TO PROVIDE THE OPERATOR WITH THE SMOOTHEST RIDE.

SAMPLE TREAD PATTERNS FROM OUR EXTENSIVE IN-STOCK SELECTION

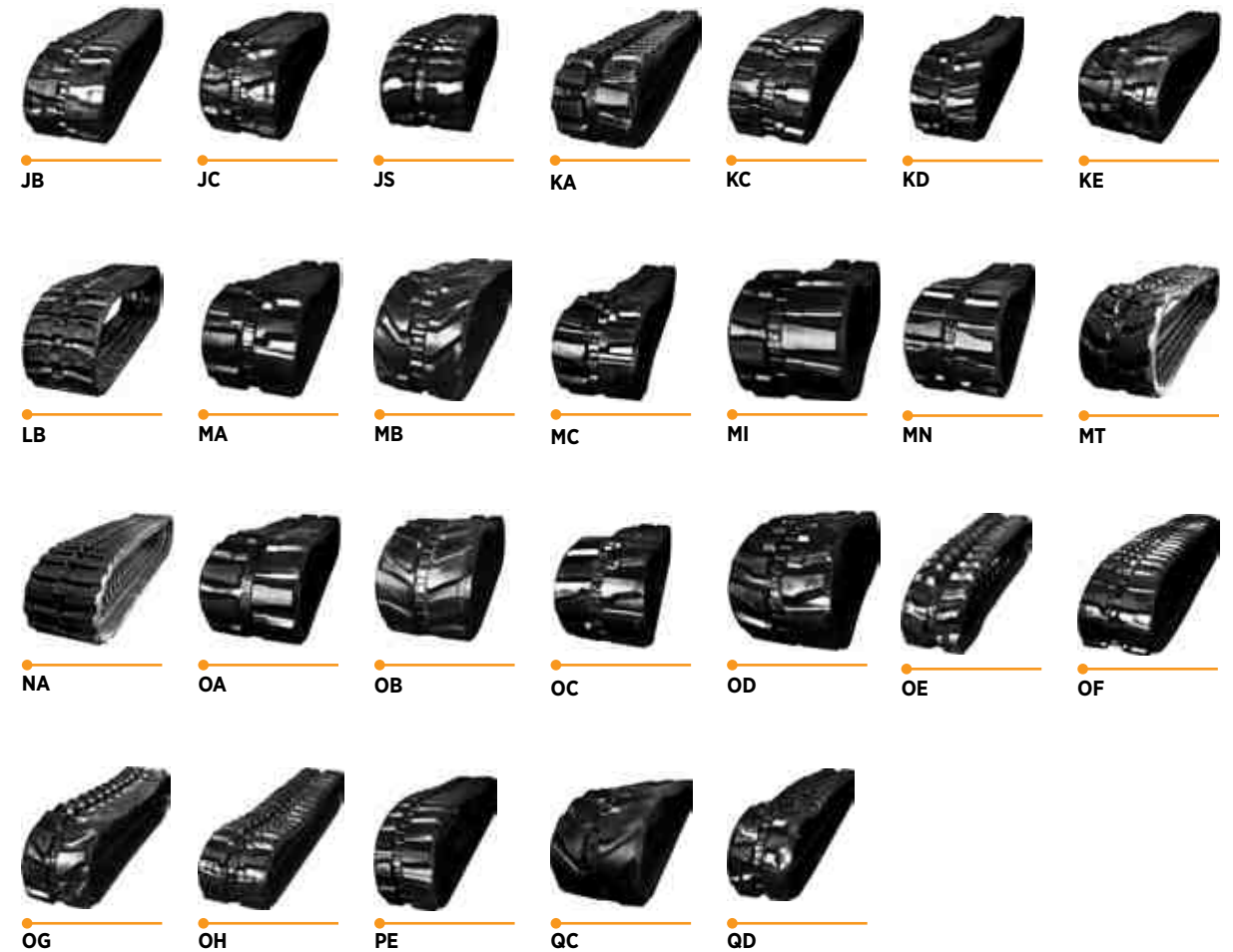

CRAWLER CARRIER & DUMPER TRACKS

SAMPLE TREAD PATTERNS
FROM OUR EXTENSIVE IN-STOCK SELECTION



NON-MARKING TRACKS

Protect finishes and keep floors clean with non-marking rubber. Any tread, tire or pad can be special ordered.

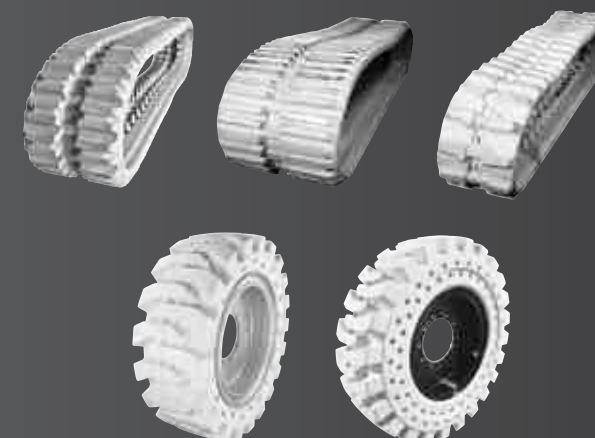

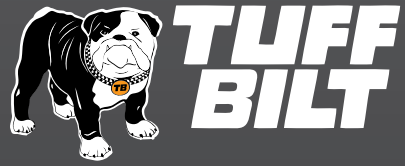

SPECIALTY TRACKS

Contrax maintains an inventory of Specialty Tracks for machines other than skid-steers, crawler carriers, etc. These machines include telescopic lifts, trenchers, pavers and more.

OUR SPECIALTY TRACKS ARE GUARANTEED TO FIT YOUR MACHINE!

WE STOCK RUBBER TRACKS TO FIT 8,000+ MACHINE MAKES AND MODELS

NON-METAL CORE TREAD PATTERNS



DRILL RIG TREAD PATTERNS



PAVER TREAD PATTERNS



OTHER SPECIALTY TREAD PATTERNS





RUBBER PADS

Extreme-duty rubber compound, protects surfaces, reduces noise, increases traction, and extends undercarriage life.

HIGH TEAR AND TENSILE STRENGTH

Prevents damage by elements in the work environment

SUPERB ELONGATION AND BONDING STRENGTH

Maintains structural integrity when torqued and stretched

OUTSTANDING ABRASION-RESISTANCE

Extends pad life, reduces downtime, and increases value

AVAILABLE IN 200-900 mm, OUR PADS ARE GUARANTEED TO FIT YOUR MACHINE!



CLIP-ON STYLE



BOLT-ON STYLE



ROADLINER STYLE

FOR SUPERIOR DURABILITY, ALL STYLES FEATURE A HARDENED, FORGED STEEL CORE

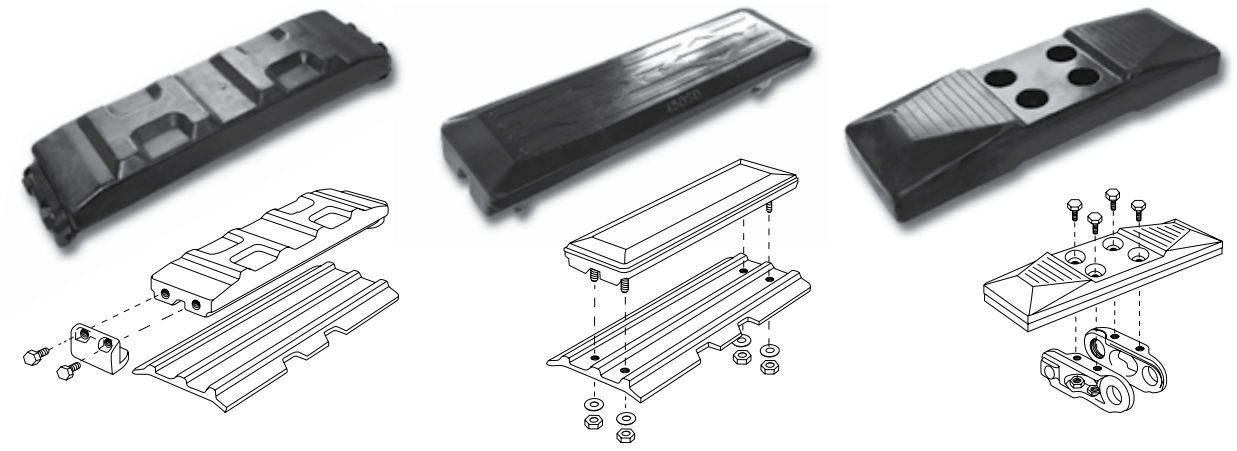

CLIP-ON STYLE

- Heaviest, most durable pad
- Warranty includes the clips and hardware
- Simple installation and quick, easy removals
- No pre-drilled holes required

BOLT-ON STYLE

- Matches the width of your machine
- Securely bolts to the triple grouser steel pad
- Pre-drilled holes required
- Protects curbs from damage

ROADLINER STYLE

- Bolts directly to the steel chain
- No steel grouser shoe required
- Four bolts are centered to increase stability
- Protects curbs from damage

SPECIALTY RUBBER PADS

TuffBilt's easy installation option for some machines is available with bolt-on and clip-on rubber pads.

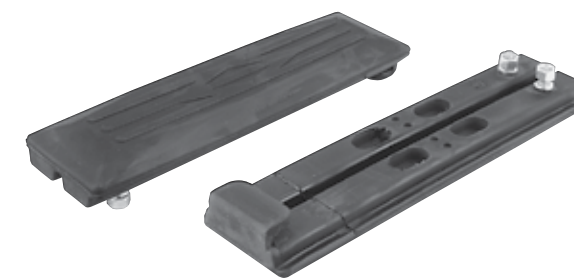

REDUCED NOISE

Decreases disruptions around the work site



MAXIMIZED TRACTION

Increases stability and safety



MINIMIZED VIBRATION

Improves operator comfort





FLATPROOF TIRES

NO MORE FLAT TIRES!

Extra heavy-duty rubber compound resists abrasion, tears, and corrosion - even in extreme situations.

- Quick and easy installation
- No downtime - Reduce maintenance costs
- Improve productivity
- Increased operator comfort
- Highest quality materials
- Aggressive tread pattern
- No rim slippage
- Bonded to the offset rim (works with over-the-tire tracks)
- Large hub (Fits Bobcat A Series S750 and S850)

OUR FLATPROOF TIRES ARE GUARANTEED TO FIT YOUR MACHINE!

Lasts 2-3 times longer than a standard air-filled tire.
(When used for the same applications)



TREADED

- Self-Cleaning Design
- Available in Multiple Tread Patterns
- Thick 2-Inch Tread for Aggressive Bite



DIAMOND TREAD

- Ideal for paving contractors, demolition and agriculture applications
- Withstand impact better due to the tread design
- Single relief hole



NON-TREADED

- Ideal for Scrap Yards, Municipal Waste Facilities, Paving Contractors

FLATPROOF TIRES FROM OUR EXTENSIVE IN-STOCK SELECTION

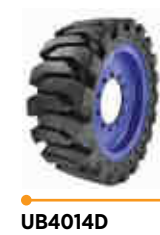

ALL FLATPROOF TIRES ARE BACKED BY OUR INDUSTRY-LEADING MANUFACTURER WARRANTY

ENJOY A SMOOTHER, CONFIDENT RIDE. DON'T WASTE VALUABLE TIME CHANGING TIRES



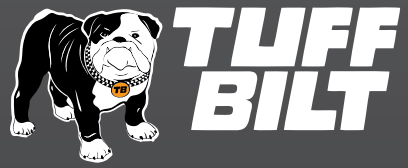

UNDER-CARRIAGE WEAR PARTS

- Highest-Quality, Hardened Steel Ensures Long Life
- Sealed Bearings Reduce Maintenance, Labor Costs and Downtime
- Precision-Manufactured to Meet or Exceed OEM Specifications
- Massive Inventory Available in Multiple Distribution Centers

INDUSTRY-LEADING PRODUCTS AND UNMATCHED SERVICE

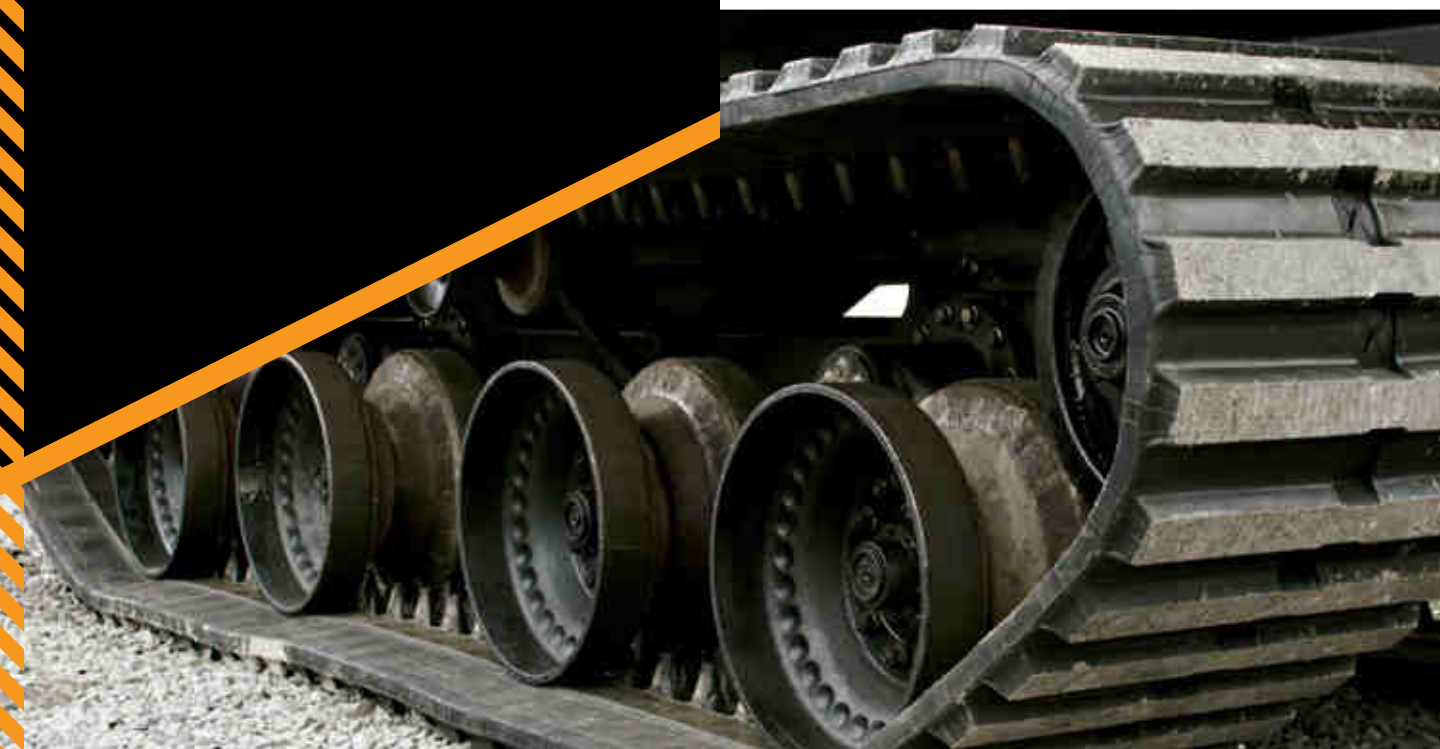

IDLER STYLES

TRACK LOADERS



EXCAVATORS



CRAWLER CARRIERS AND DUMPERS



OTHER



BOTTOM ROLLER STYLES

TRACK LOADERS



EXCAVATORS



CRAWLER CARRIERS AND DUMPERS



OTHER



SPROCKET STYLES

TRACK LOADERS



EXCAVATORS



CRAWLER CARRIERS AND DUMPERS



OTHER



TOP ROLLER STYLES

EXCAVATORS



CRAWLER CARRIERS AND DUMPERS



QUALITY CONSTRUCTION WEAR PARTS

FROM A BRAND YOU CAN TRUST

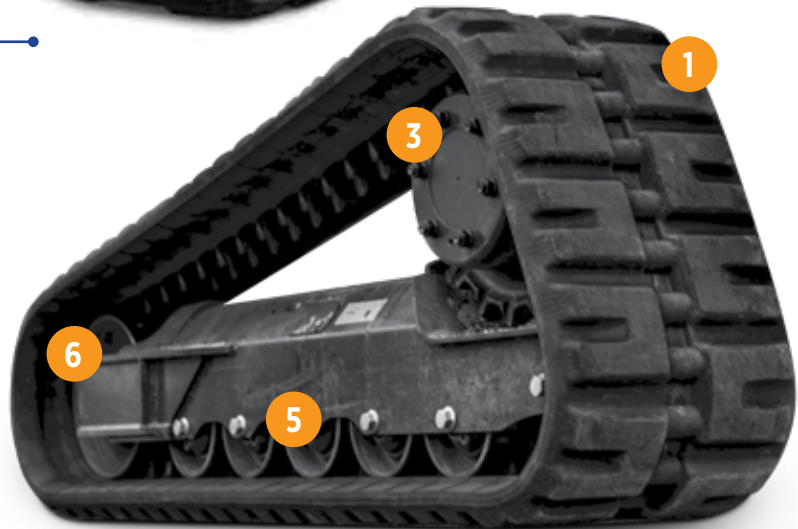
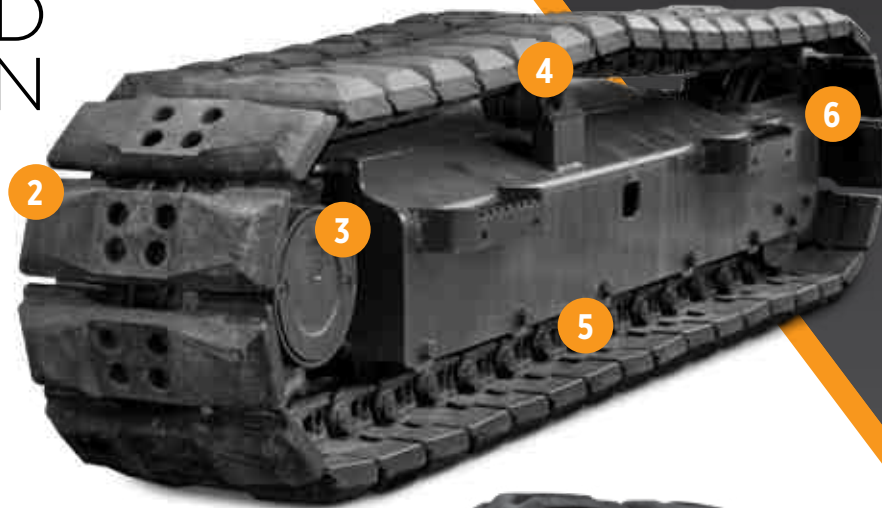

- 1 RUBBER TRACKS
- 2 RUBBER PADS
- 3 SPROCKETS
- 4 TOP ROLLERS
- 5 BOTTOM ROLLERS
- 6 IDLERS



HOW TO MEASURE RUBBER TRACKS REFERENCE GUIDE

Before you order, be sure you have the following information.

- A** WIDTH
Measure the distance from edge to edge.
- B** PITCH
Measure the distance from the center of one link to the center of the next one.
- C** LINKS
Count the total number of links.
- D** SERIAL NUMBER
If you see a serial number and/or size code, write it down

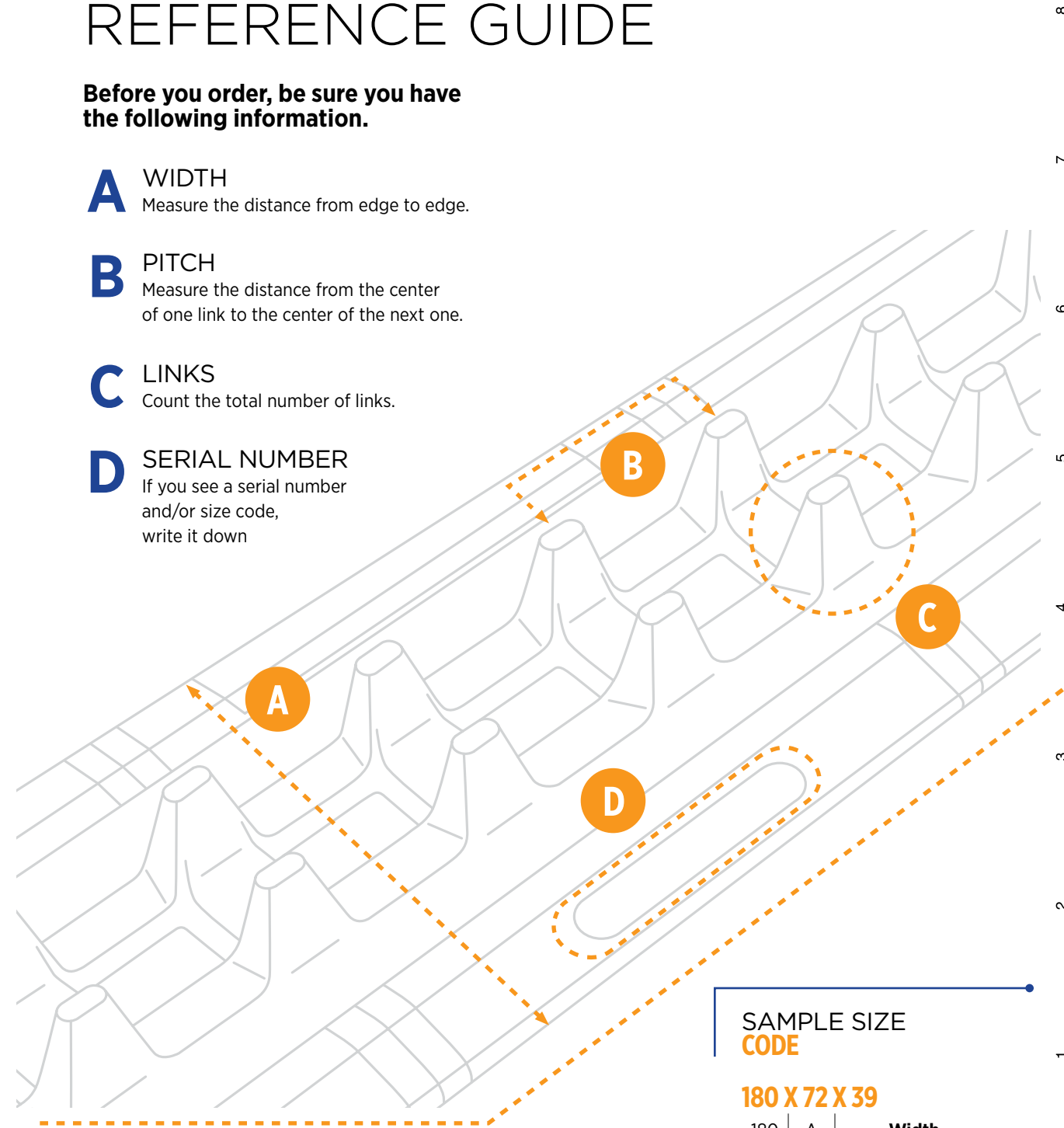

SAMPLE SIZE CODE

180 X 72 X 39

180	A	Width
72	B	Pitch
39	C	Number of Links

Conversion Ratio:
1 inch = 25.4mm

HOW TO MEASURE RUBBER PADS

GROUSER MEASUREMENTS WORKSHEET

Taking the time to properly measure your rubber pads will make the ordering process easier and faster.

BOLT-ON

ROADLINER

CLIP-ON

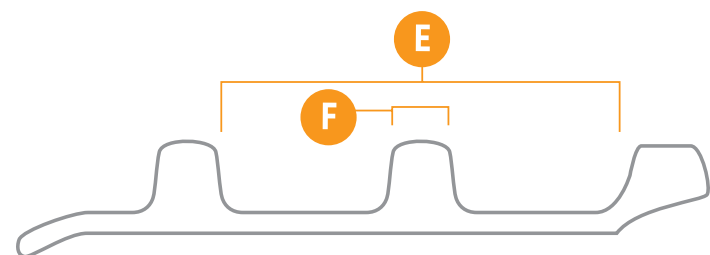
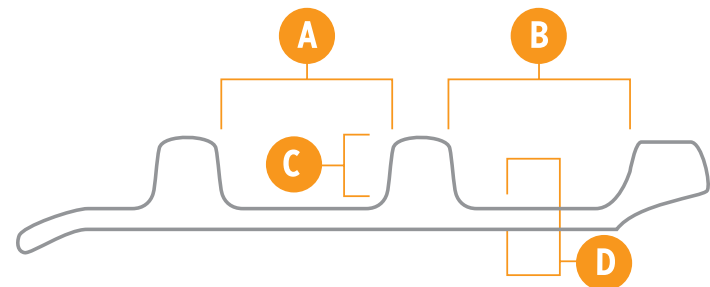
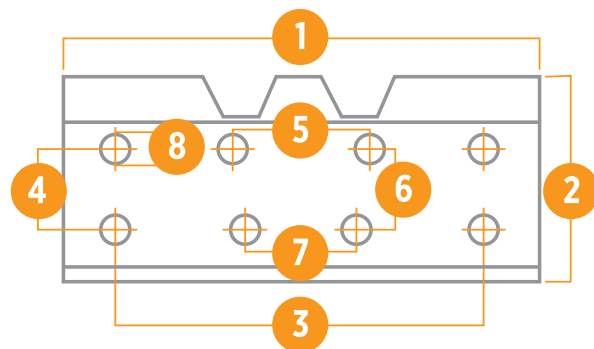
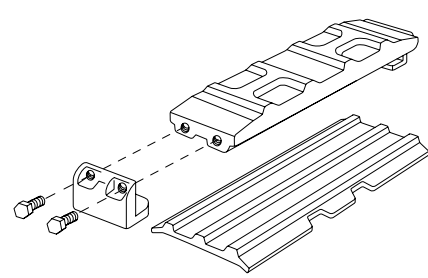
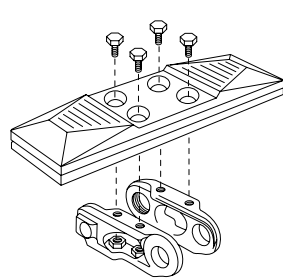
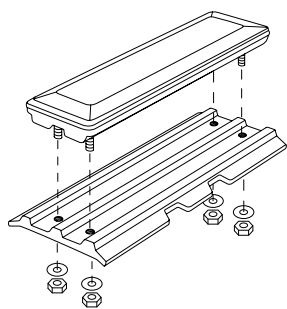

- 1 ●●●
- 2 Not Required
- 3 ●
- 4 ●
- 5 ●●
- 6 ●●
- 7 ●●
- 8 ●

- A ●●
- B ●●
- C ●●
- D ●●
- E ●●
- F ●●

HOW TO MEASURE TIRES

REFERENCE GUIDE

Before you order, be sure you have the following information.

A WIDTH
Measure from one side of the tire to the other, at the widest part.

B HEIGHT
Measure the distance between the top and the bottom of the tire.

C HUB DIAMETER
Measure from one side of the hub to the other, at the widest part.

D RIM DIAMETER
Measure from one side of the rim to the other, at the widest part.

E NUMBER OF BOLT HOLES
Count the holes (for example, the drawing shown here has 8).

F BOLT HOLE DIAMETER
Confirm the diameter of the bolt hole.

G STUD CENTER
Measure from the center of a stud to the center of the one across from it.

